

House In Never Never Land

Andres Jaque Arquitectos

Γιάννος Κολιαντρής, Αντρέας Παναγιώτου, Άννινος Νικολάου

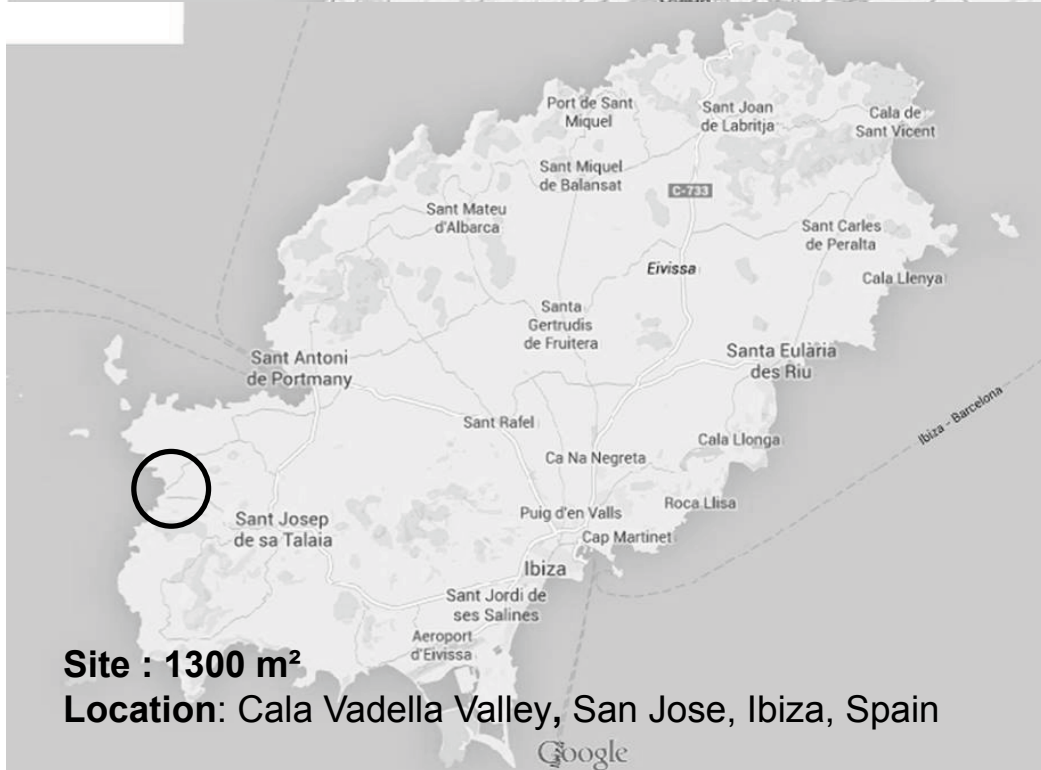



Site : 1300 m²

Location: Cala Vadella Valley, San Jose, Ibiza, Spain

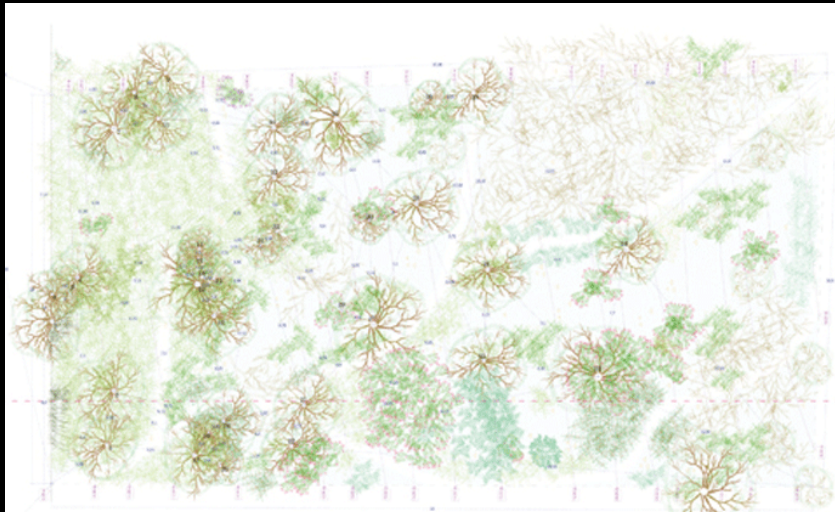

Idea:

The project's idea=>based on three main concepts:

1. integration with the natural surroundings
2. incorporation of desire society
3. getting financial security for the future.

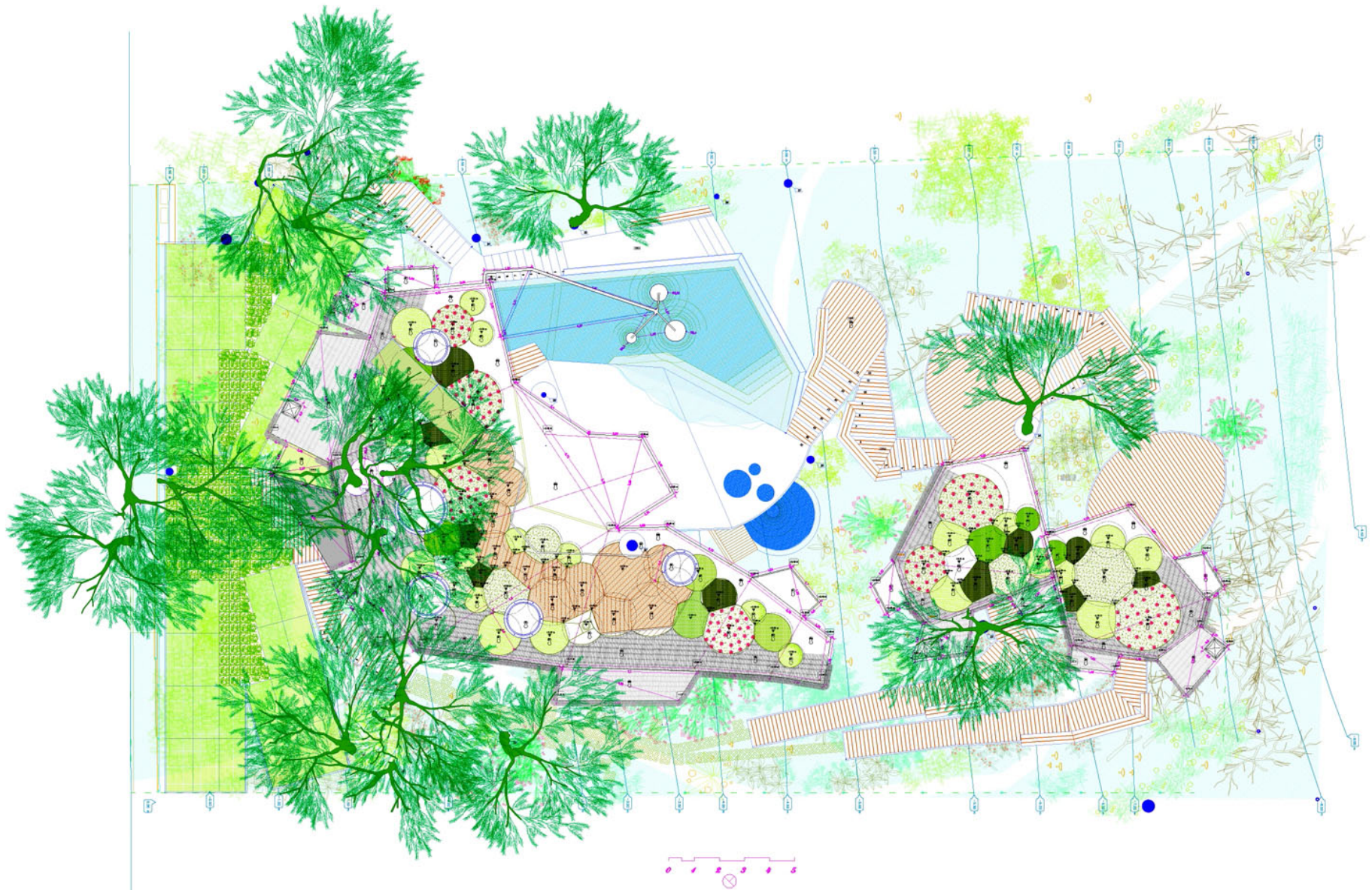

Aims:

- to adapt the geometry of the house to the existing vegetation
- to carve out the construction in the open spaces between the trees and bushes
- to the extent of incorporating trees at certain points.



⇒ built in and among the existing features of the site
⇒ trees are growing up through the interiors of some of the rooms



The house opens up completely to the environment



The project consists of:

- the main house,
- two rentable cabins which are independent

ACCESS VIA BRIDGES



How it looks like the shape in general of the main building, the two cabins and the access points

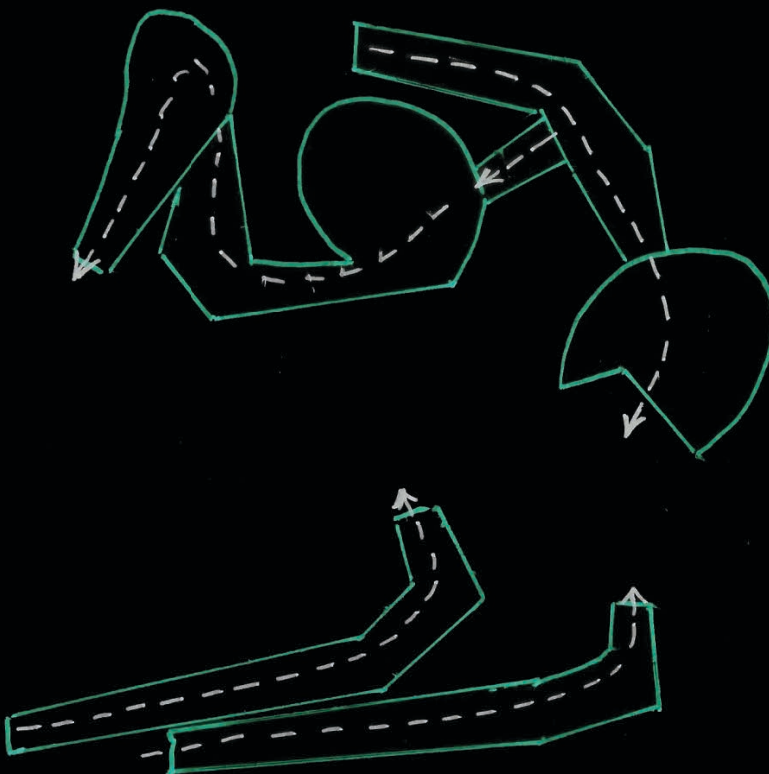
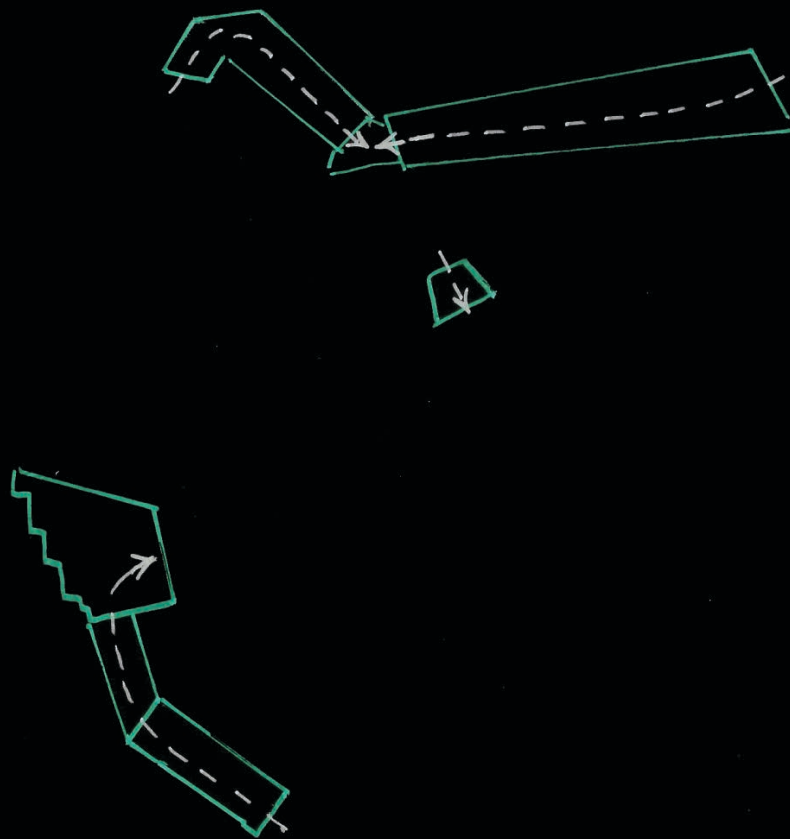

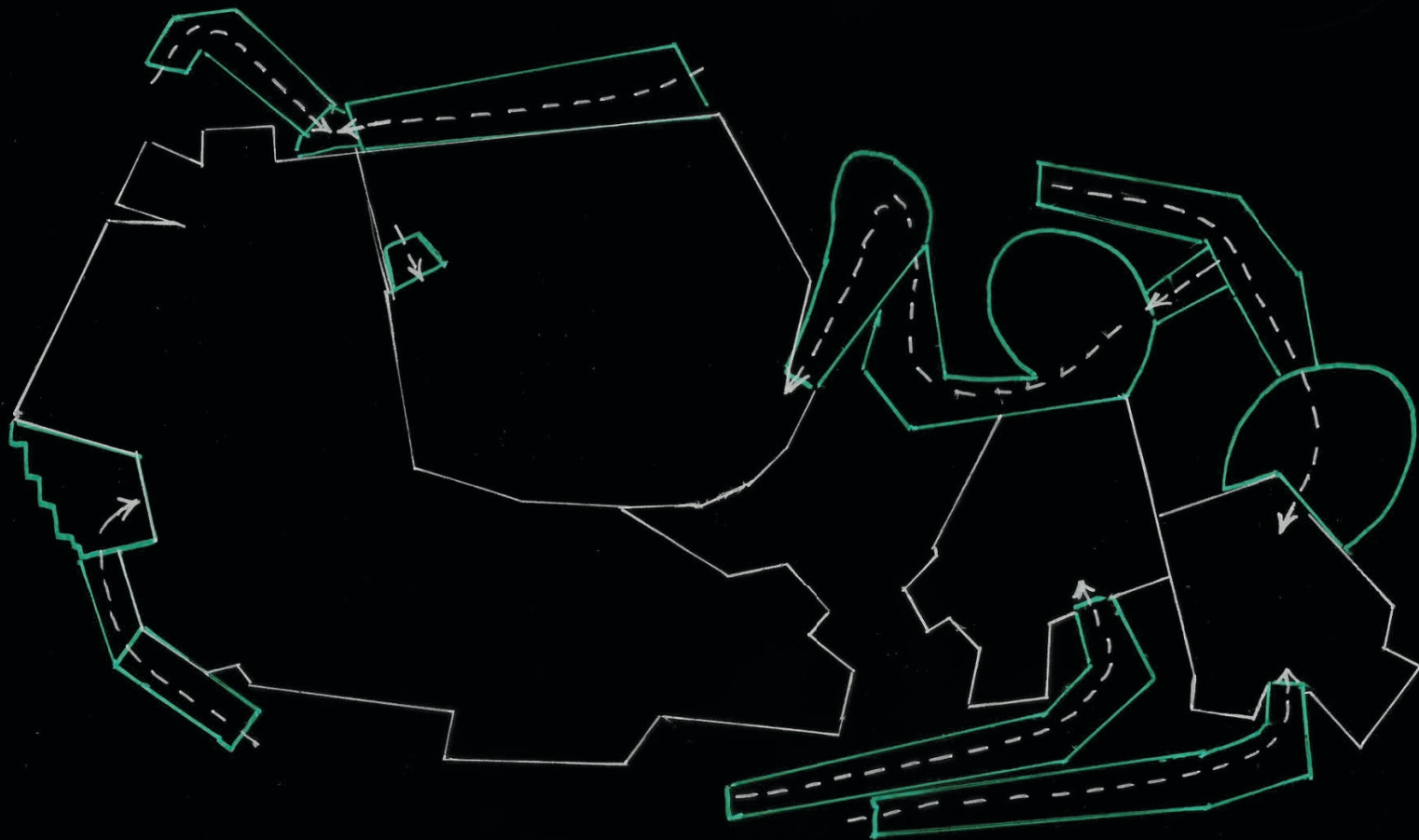

The three buildings can exist as one and at the same time as three independent units.



An access to the first cabin



In the current economic climate => buying property is seen as a way of guaranteeing one's future financial security
Because of that reason, the architect designed an ensemble of three distinct elements:

- a main house
- plus two independent cabins => could be rented out in the future.

EACH BUILDING :

- MEETS THE REQUIREMENTS OF THE HOLIDAY RENTAL MARKET
- HAS SEPARATE ACCESS AND FACILITIES.



The slope of the land ensures that each unit enjoy:
=>an uninterrupted view of the sea
=> its own piece of garden

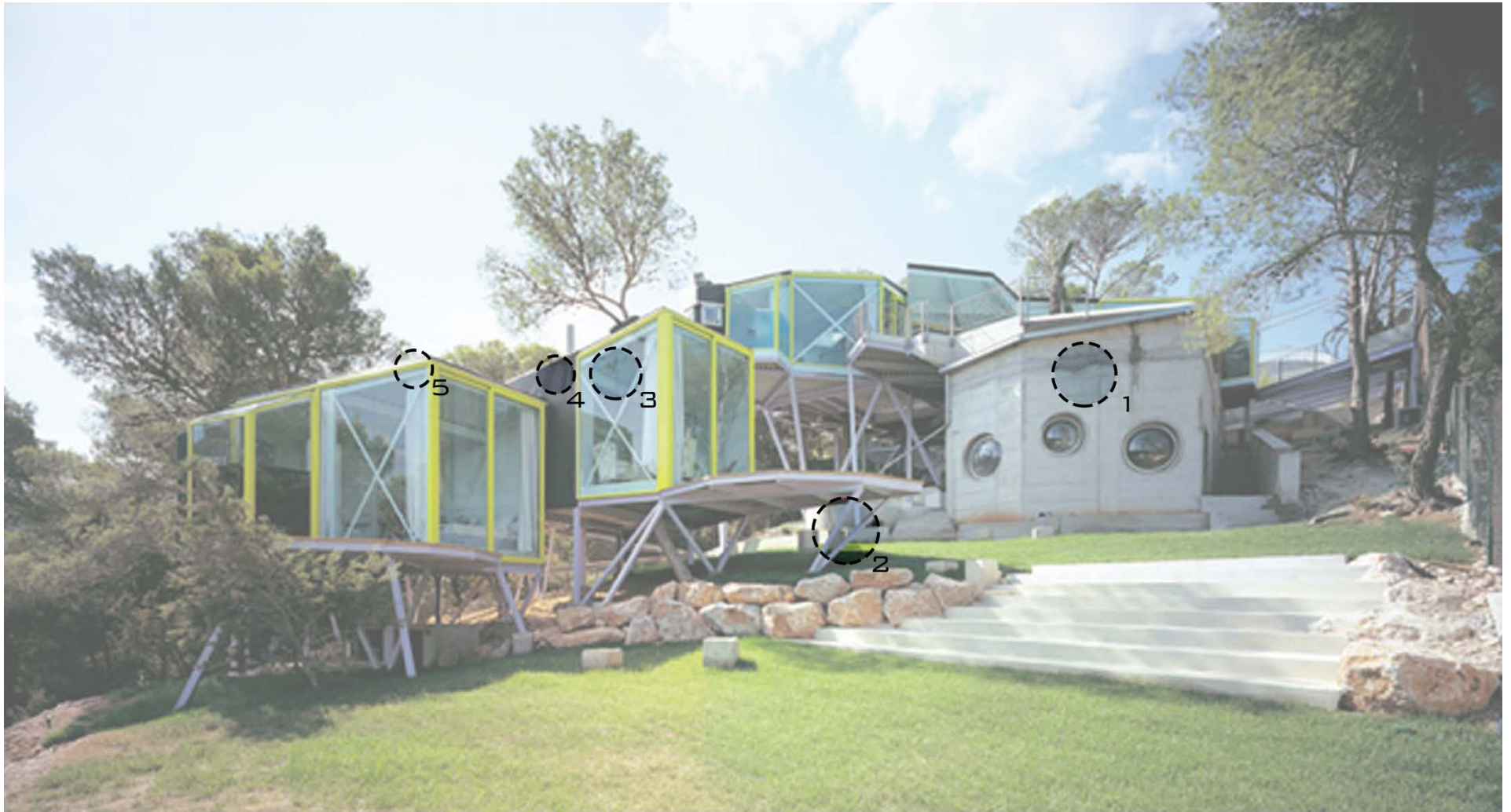

Metal Elevated
Terraces

Glass

Fabric

Metal
Stilts

Concrete

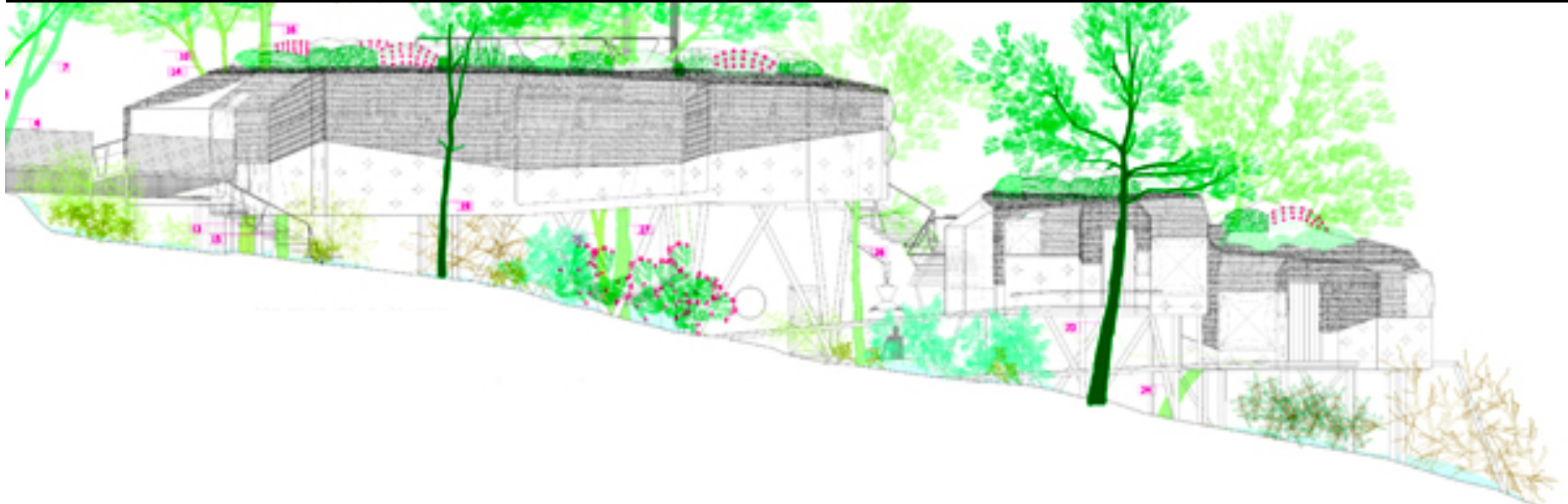

- The main part of the house is supported on a concrete structure
- the elevated terraces are supported on a metal frame.

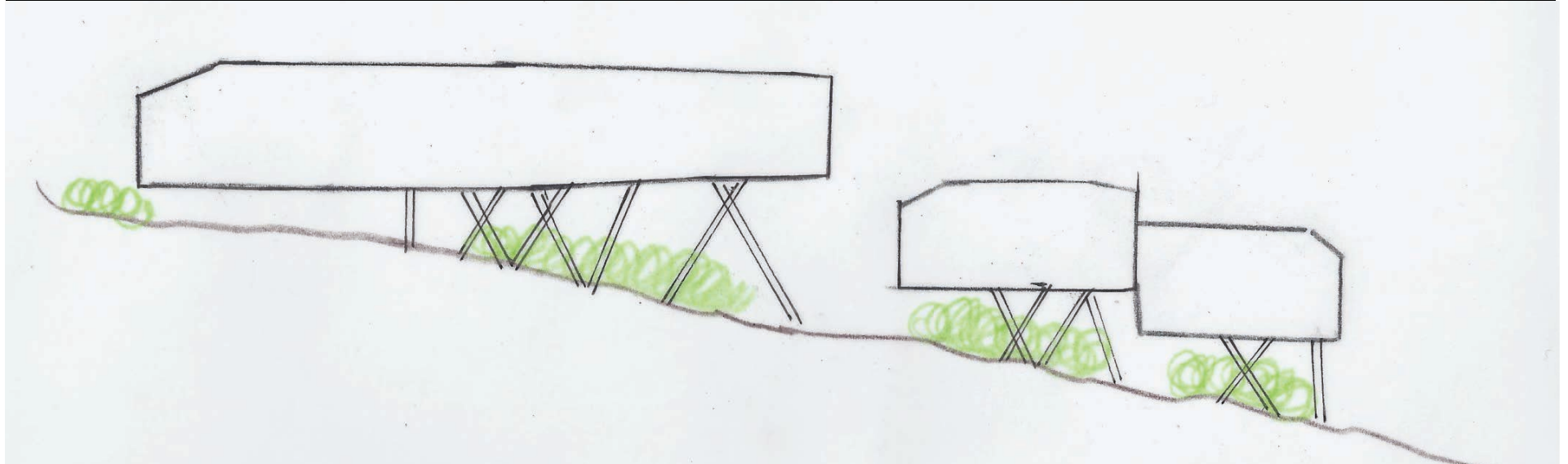



Elevated terraces+>supported on stilts





The pool as well as the main building is supported on a concrete **structure**.

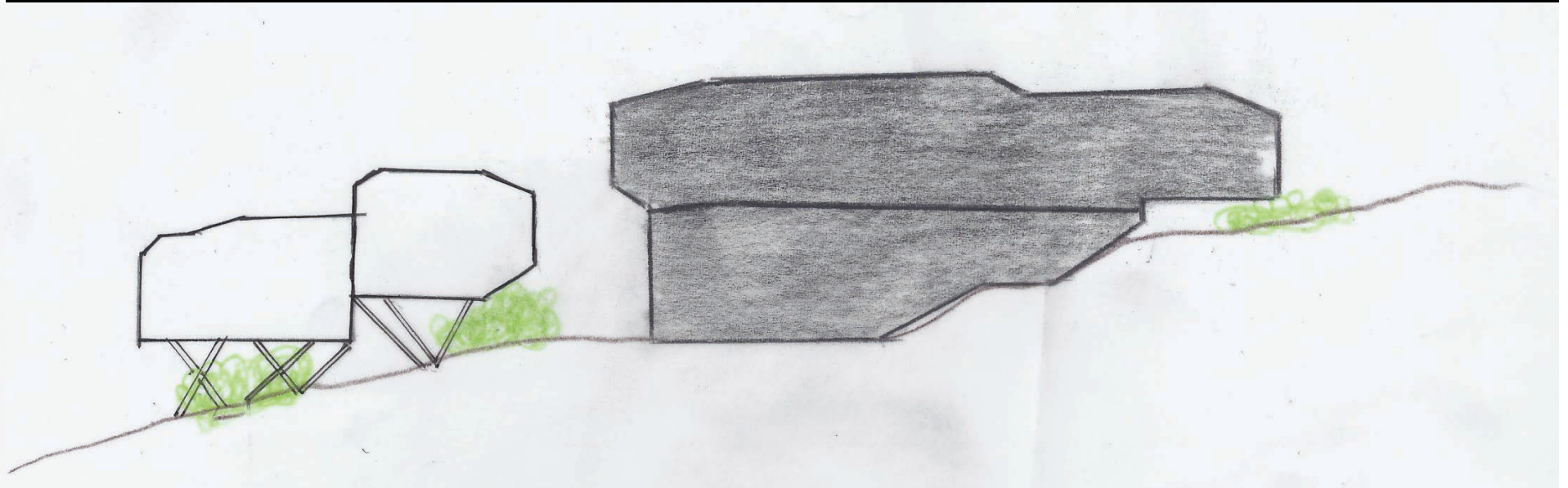



The pool as well as the main building is supported on a concrete **structure**.

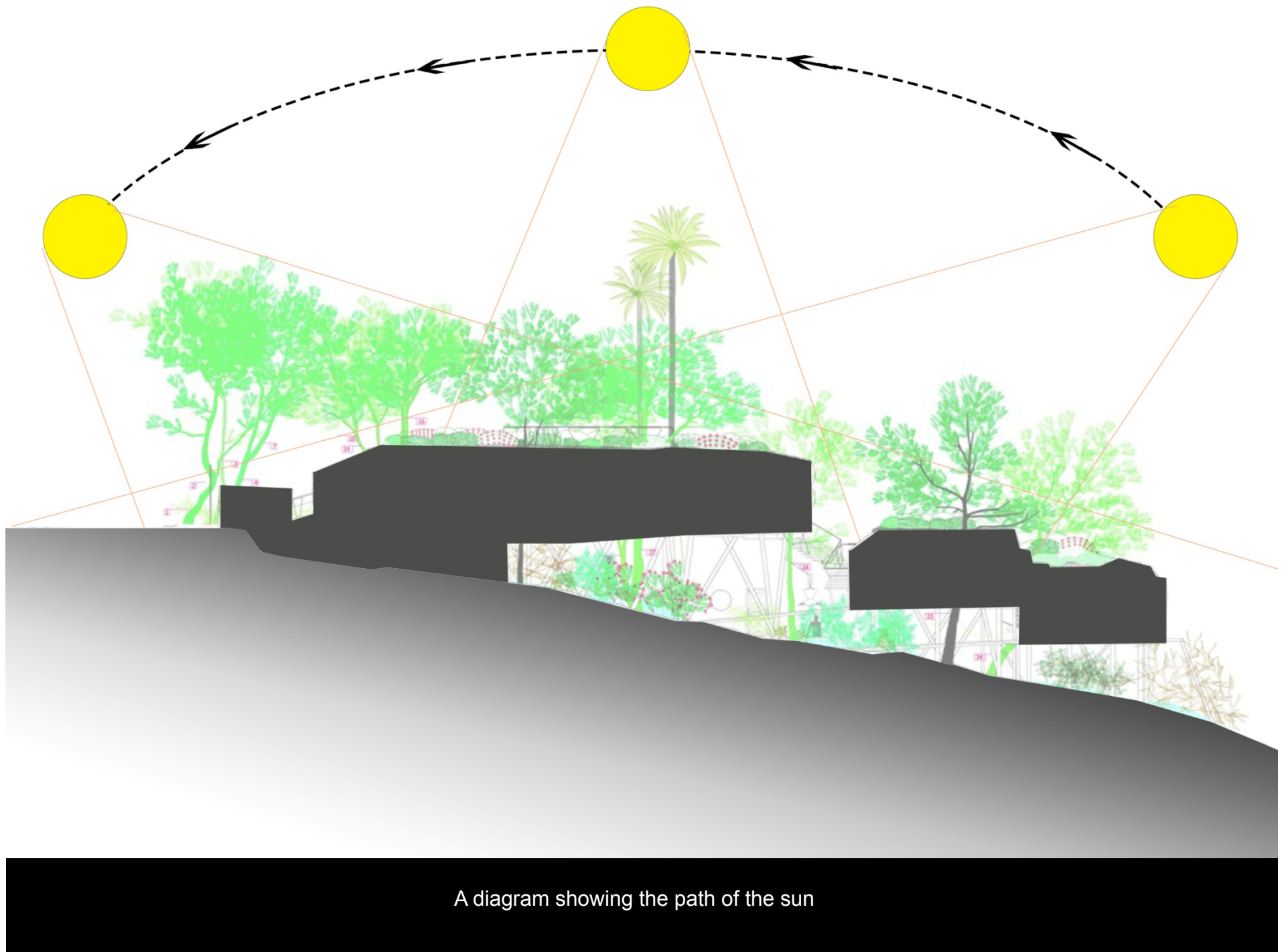

A diagram showing the path of the sun

Adaptability



Limits







In this conceptual model, it is shown, the use of the site as a land with inviolable limits (the trees) and how the house can sneak in between those limits.

The metal wire symbolizes the trees, and with card board it is shown the house, and how the house can enter the earth with the less possible destroy. The rope shows the link between the nature, which should reflect how the house spaces have to be linked.

